

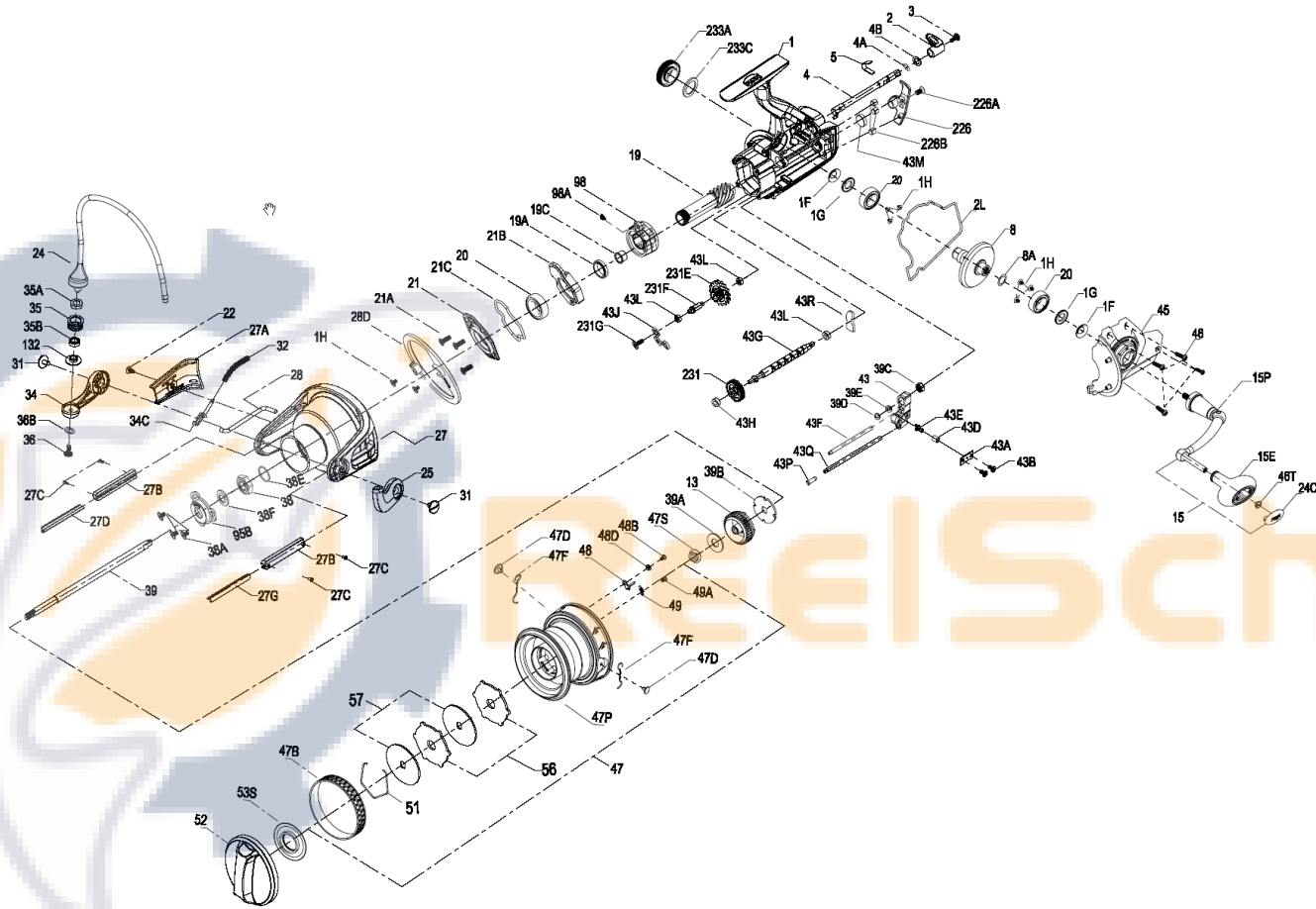

# PARTS LIST FOR MODEL SSVII6500LC-US / SSVII6500LC-EU



| KEY NO. | PART NO. | PENN STYLE NO.   | DESCRIPTION                   |
|---------|----------|------------------|-------------------------------|
| 27D     | 1494854  | 27D-SSVI6500LC   | Line Guard                    |
| 27G     | 1494855  | 27G-SSVI6500LC   | Line Guard                    |
| 28      | 1494856  | 28-SSVI6500LC    | Bail Trip Lever               |
| 28D     | 1494832  | 28D-SSVI5500LC   | Rotor Brake                   |
| 31      | 1277055  | 31-SSV5500       | Arm Lever Screw               |
| 32      | 1277162  | 32-SSV7500       | Bail Spring                   |
| 34      | 1389468  | 34-CLA6000       | Bail Arm                      |
| 34C     | 1389469  | 34C-CLA6000      | Pivot Arm                     |
| 35      | 1277059  | 35-SSV5500       | Line Roller                   |
| 35A     | 1457404  | 35A-SLAIH6500HS  | Bushing                       |
| 35B     | 1377606  | 35A-BTLII8000LC  | Ball Bearing                  |
| 36      | 1277166  | 36-SSV7500       | Line Roller Screw             |
| 36B     | 1417809  | 36B-CLA6000      | Washer                        |
| 38      | 1419051  | 38-SLA5500       | Rotor Nut                     |
| 38A     | 1119121  | 20C-7000AF       | Rotor Nut Screw               |
| 38E     | 1418958  | 38E-SLA3500      | Pinion Gear Seal              |
| 38F     | 1419052  | 38F-SLA5500      | Rotor-Main Shaft Seal         |
| 39      | 1494857  | 39-SSVI6500LC-US | Main Shaft                    |
| 39      | 1494858  | 39-SSVI6500LC-EU | Main Shaft                    |
| 39A     | 1122023  | 39A-7000AF       | Washer                        |
| 39B     | 1294641  | 39B-7000AF       | Washer                        |
| 39C     | 1483101  | 39C-CFTII4000LC  | Main Shaft Nut                |
| 39D     | 1483147  | 39D-CFTII5000LC  | Rubber pad                    |
| 39E     | 1483148  | 39E-CFTII5000LC  | Fixing plate                  |
| 43      | 1483149  | 43-CFTII5000LC   | Oscillation Slider            |
| 43A     | 1259635  | 43A-7000AF       | Slider Retainer Plate         |
| 43B     | 1276992  | 14-SSV6500LL     | O/S Slider Retainer Screw     |
| 43D     | 1122193  | 43D-7000AF       | Oscillation Slide Bushing     |
| 43E     | 1122192  | 43E-7000AF       | Guide Claw                    |
| 43F     | 1483150  | 43F-CFTII5000LC  | Right Guide Shaft             |
| 43G     | 1494859  | 43G-SSVI6500LC   | Worm Shaft                    |
| 43H     | 1377609  | 43H-BTLII8000LC  | Worm Shaft Ball Bearing       |
| 43J     | 1483154  | 43J-CFTII5000LC  | Worm Shaft Top Retainer Plate |
| 43L     | 1341533  | 43L-SSV7500LC    | Worm Shaft Lower Bushing      |
| 43M     | 1341534  | 43M-SSV7500LC    | Worm Shaft Seal               |
| 43P     | 1494846  | 43P-SSVI5500LC   | Guide Shaft Seal              |
| 43Q     | 1483151  | 43Q-CFTII5000LC  | Left Guide Shaft              |
| 43R     | 1483155  | 43R-CFTII5000LC  | Rear Retainer Plate           |
| 45      | 1494860  | 45-SSVI6500LC    | Body Cover Assembly           |
| 46      | 1277074  | 46-SSV5500       | Body Cover Screw              |
| 46T     | 1494762  | 46T-SSVI6500LL   | Screw                         |
| 47      | 1610969  | 47-SSVI6500LC    | Spool Assembly                |
| 47B     | 1483162  | 47B-CFTII5000LC  | Spool Band                    |
| 47D     | 1483163  | 47D-CFTII5000LC  | Line Clip                     |
| 47F     | 1483164  | 47F-CFTII5000LC  | Line Clip Retainer            |
| 47P     | 1610970  | 47P-SSVI6500LC   | Spool                         |
| 47S     | 1494845  | 47S-SSVI5500LC   | Seal                          |
| 48      | 1483167  | 48-CFTII5000LC   | Spool Clicker Plate           |
| 48B     | 1385581  | 48B-CLA3000      | Spool Clicker Screw           |
| 48D     | 1341546  | 48D-SSV7500LC    | Spool Clicker Spacer Ring     |
| 49      | 1259579  | 49-7000AF        | Spool Clicker Spring          |
| 49A     | 1341547  | 49A-SSV7500LC    | Spool Clicker Spring Screw    |
| 51      | 1447925  | 51-CFTII5000     | Drag Ring                     |
| 52      | 1494863  | 52-SSVI6500LC-US | Drag Knob Assembly            |
| 52      | 1494864  | 52-SSVI6500LC-EU | Drag Knob Assembly            |
| 53S     | 1483237  | 53S-CFTII8000LC  | Drag Knob Seal                |
| 56      | 1341550  | 56-SSV7500LC     | Drag Friction Washer          |
| 57      | 1378421  | 57-BTLII7000LC   | Drag Keyed Washer             |
| 95B     | 1494841  | 95B-SSVI5500LC   | Rotor Locking Plate           |
| 98      | 1494842  | 98-SSVI5500LC    | Clutch Assembly               |
| 98A     | 1378449  | 98A-BTLII8000LC  | Clutch Assembly Spring        |
| 132     | 1419049  | 132-SLA5500      | Line Roller Collar            |
| 226     | 1494843  | 226-SSVI5500LC   | Rear Cover                    |
| 226A    | 1341553  | 226A-SSV7500LC   | Rear Cover Screw              |
| 226B    | 1341554  | 226B-SSV7500LC   | Body Rear Seal                |
| 231     | 1483175  | 231-CFTII5000LC  | Oscillation Gear              |
| 231E    | 1483176  | 231E-CFTII5000LC | Slow O/S Gear                 |
| 231F    | 1483177  | 231F-CFTII5000LC | Slow O/S Gear Pin             |
| 231G    | 1494844  | 231G-SSVI5500LC  | Screw                         |
| 233A    | 1419118  | 233A-SLA7500     | Handle Cap Assembly           |
| 233C    | 1419076  | 233C-SLA5500     | Handle Cap Seal               |
| 1       | 1610967  | 1-SSVII6500LC    | Body Assembly                 |
| 1       | 1610968  | 1-SSVII6500LCEU  | Body Assembly                 |
| 1F      | 1419019  | 1F-SLA5500       | Body Side Seal                |
| 1G      | 1419020  | 1G-SLA5500       | Body Side Seal Lock Plate     |
| 1H      | 1418957  | 1H-SLA3500       | Body Side Screw               |
| 2       | 1341498  | 2-SSV7500LC      | A/R Button                    |
| 2L      | 1494818  | 2L-SSVI5500LC    | Body Seal                     |
| 3       | 1341500  | 3-SSV7500LC      | A/R Button Screw              |
| 4       | 1483122  | 4-CFTII5000LC    | A/R Pawl / Lever              |
| 4A      | 1341502  | 4A-SSV7500LC     | A/R Lever Seal                |
| 4B      | 1361929  | 4B-SSV7500LC     | A/R Lever Washer              |
| 5       | 1483123  | 5-CFTII5000LC    | A/R Pawl / Lever Spring       |
| 8       | 1611035  | 8-SSVII6500LC    | Drive Gear                    |
| 8A      | 1277037  | 8A-SSV5500       | Drive Gear Shim Washer        |
| 13      | 1294640  | 13-7000AF        | Clicker Gear                  |
| 15      | 1494820  | 15-SSVI6500LC    | Handle Assembly               |
| 15E     | 1494749  | 15E-SSVI6500LL   | Handle Knob                   |
| 15P     | 1494821  | 15P-SSVI5500LC   | Sub-Handle Assembly           |
| 19      | 1494822  | 19-SSVI5500LC    | Pinion Gear                   |
| 19A     | 1483128  | 19A-CFTII5000LC  | Pinion Gear Washer            |
| 19C     | 1339492  | 19C-CLA 5000     | Pinion Gear POM Bushing       |
| 20      | 1308090  | 20-CFT5000       | Ball Bearing                  |
| 21      | 1494823  | 21-SSVI5500LC    | Pinion Bearing Retainer       |
| 21A     | 1277044  | 21A-SSV5500      | Screw                         |
| 21B     | 1494824  | 21B-SSVI6500LC   | Collar                        |
| 21C     | 1494825  | 21C-SSVI5500LC   | Collar Seal                   |
| 22      | 1276928  | 22-SSV3500       | Rotor Cover Screw             |
| 24      | 1494850  | 24-SSVI6500LC    | Bail Assembly                 |
| 24C     | 1494753  | 24C-SSVI6500LL   | Handle Knob Cap               |
| 25      | 1339500  | 25-CLA5000       | Bail Holder                   |
| 27      | 1494851  | 27-SSVI6500LC    | Rotor                         |
| 27A     | 1494852  | 27A-SSVI6500LC   | Rotor Cover                   |
| 27B     | 1494853  | 27B-SSVI6500LC   | Line Guard Holder             |
| 27C     | 1341516  | 27C-SSV7500LC    | Line Guard Holder Screw       |

407-SSVII6500LC Rev.00 21-04-2023  
 1594607-SSVII6500LC-US  
 1595351-SSVII6500LC-EU